

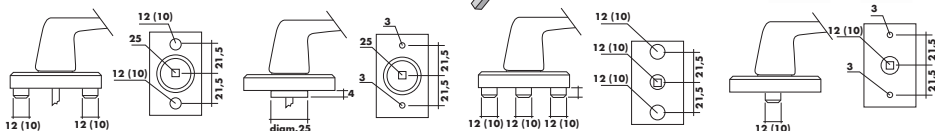

## TRIMATIC 43/0 for cremone bolts



The equipment as it appears at the time of purchase (see photo 1)

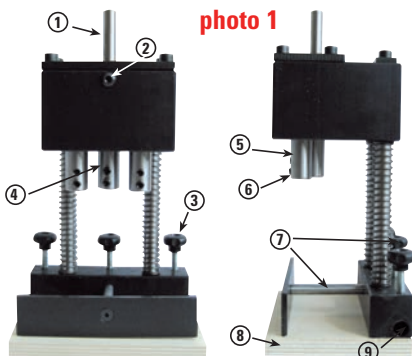
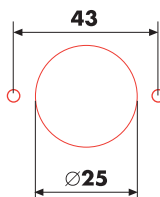

photo 1

- 1) Fitting for drill spindle
- 2) Threaded hole for greasing
- 3) Locking knob for stop reference rod
- 4) Distance adjusting screw "B"
- 5) Tool holder bush
- 6) Tool locking screw
- 7) Distance adjusting screw "A"
- 8) Equipment support table
- 9) Stop rod sliding hole

Fig. 1



### Equipment setup and operating phases

Disassemble the support table (8) and position the equipment on a suitable surface for the type of work. Procure a rod with  $\varnothing$  10 mm. and length suitable for the job to be carried out and insert it in the hole (9). Position the reference stop and lock the whole assembly with the knobs (3). Fix one or more reference blocks on the work surface depending on the length of the window to be drilled. Finally, position the door to be drilled (see Fig. 2).

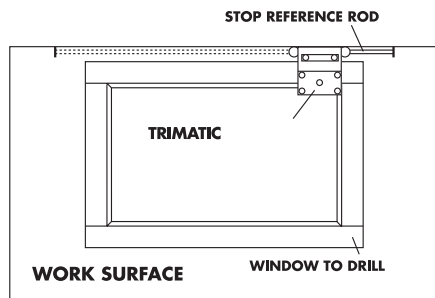
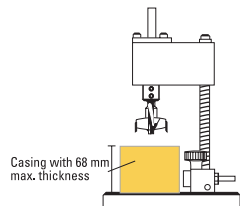
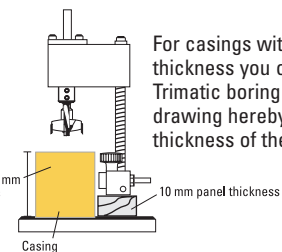

Fig. 2



For casings with 68 mm. max. thickness you are suggested to use our Trimatic boring jig as shown in the drawing hereby



For casings with more than 68 mm. thickness you can shim our Trimatic boring jig as shown in the drawing hereby 78-68=10 mm thickness of the shim to use



**Klein**  
S I S T E M I

www.sistemiklein.com

foto 2

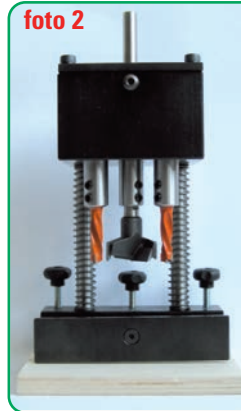

### TRIMATIC 43/0

Drilling of wood and PVC window frames to fit cremone bolt

$\varnothing$	Rot.	Cod.	$\varnothing$	Rot.	Cod.
3	LH	L120.030.L + Z011.030.N	12	RH-LH	L103.120.R/L
4	RH-LH	L103.040.R/L	25	RH	L140.250.R
5	RH-LH	L103.050.R/L	26	RH	L140.260.R
8	LH	L103.080.L	35	RH	L140.350.R
10	RH-LH	L103.100.R/L	40	RH	L140.400.R

Mount the right-hand rotation bit on the central bush and lock it with the screws (6), mount the left-hand rotation drills on the lateral bushes and lock them with the screws (6) (see photo 2)

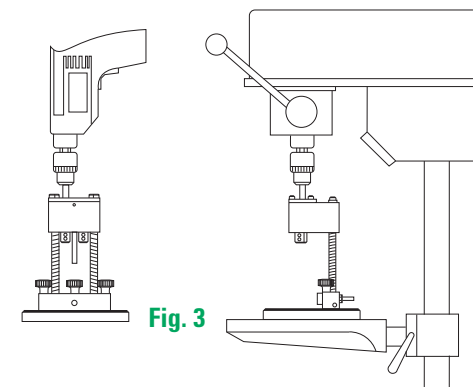
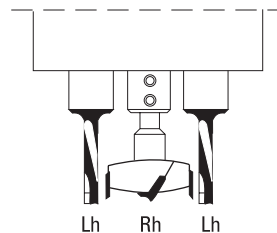

Fig. 3

When the equipment has been set up, all that is required is an electric drill (recommended power 0,75 kw) to be mounted on the spindle (1) or alternatively, a pillar drill may be used (see Fig. 3).

## The production range of TRIMATIC also includes

**TRIMATIC 22 - 25 - 28** help the window makers to make holes for angular hinges to be mounted on windows and door-windows, in wood and wood-aluminium material.

**TRIMATIC** are dedicated to craftsmen and hobbyists who have drilling problems when fitting hinges or positioning shelves with holes at a distance between centres of 32 mm.



**TRIMATIC SUPER** can be easily and quickly mounted on the multi-spindles head of any automatic boring machine with 32 mm distance between centres chucks.



**II TRIMATIC 32** unit with five tool holders is suitable to make a five holes set with distance between centres of 32 mm. in a single pass.

www.sistemiklein.com