



TRIMATIC 32 for holes at a distance between centres of 32 mm

SISTEMI as always sensitive to indications from and problems of its clientele, has expanded its range of products aimed at craftsmen and hobbyists who have drilling problems. TRIMATIC 32 is a device designed to drill holes in lateral panels (sides) of furniture where pins for shelves, hinges, etc. are normally fitted. TRIMATIC 32, like all our articles, maintains the characteristics which distinguishes us in the market, that is: simplicity, speed and accuracy in work performance. TRIMATIC 32 is a drilling jig for five holes with distance between centres of 32 mm (see Fig. 1).

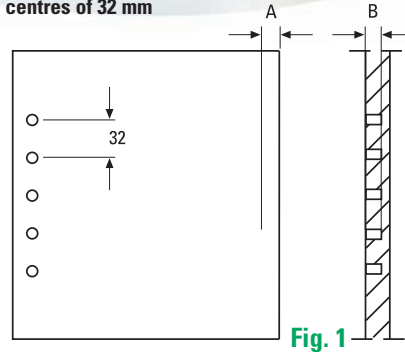

Fig. 1

The equipment as it appears at the time of purchase (see Fig. 2)

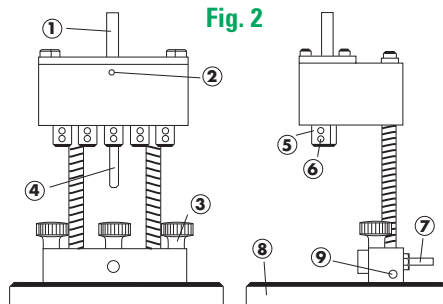
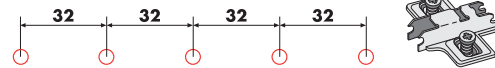

Fig. 2

- 1) Fitting for drill spindle
- 2) Threaded hole for greasing
- 3) Locking knob for stop reference rod
- 4) Distance adjusting screw "B"
- 5) Tool holder bush
- 6) Tool locking screw
- 7) Distance adjusting screw "A"
- 8) Equipment support table
- 9) Stop rod sliding hole

Equipment setup and operating phases

Disassemble the support table (8) and position the equipment on a surface suitable for the type of work. Procure a rod with $\varnothing 10$ and length suitable for the job to be carried out and insert it in the hole (9). Position the reference stop and lock the whole assembly with the knobs (3). Fix one or more reference blocks on the work surface depending on the length of the door to be drilled. Adjust the screws (7) and (4) (See Fig. 2) according to the distances "A" and "B" (see Fig. 1). Finally, position the door to be drilled (see Fig. 3)

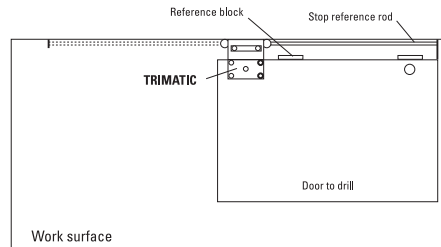
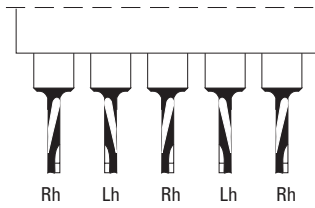

Fig. 3



Fig. 4



HW tools suitable for TRIMATIC 32

\varnothing	Rot.	Cod.
4	Rh	L103.040.R
4	Lh	L103.040.L
5	Rh	L103.050.R
5	Lh	L103.050.L

The central bit and those mounted in the external positions have right hand rotation, the other tools have left hand rotation.

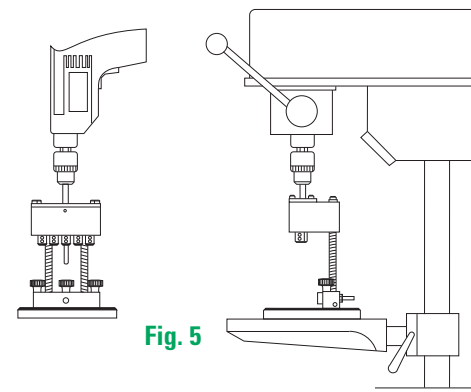
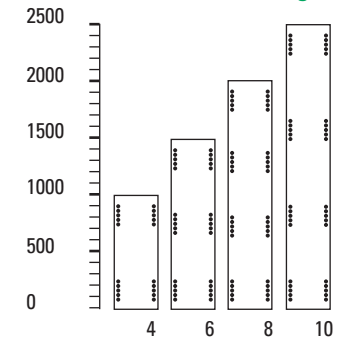

Fig. 5

Fig. 6



Having selected the type of drill, you can start drilling. Since a complete drilling cannot be carried out as with panels machined in series, we suggest a diagram which represents the number of group of 5 holes recommended depending on the panel height. (see Fig. 6)

When the equipment has been set up, all that is required is an electric drill (recommended power 0,75 kw) to be mounted on the spindle (1) or alternatively, a pillar drill may be used (see Fig. 5).

The production range of TRIMATIC also includes

TRIMATIC 22 - 25 - 28 help the window makers to make holes for angular hinges to be mounted on windows and door-windows, in wood and wood-aluminium material.

TRIMATIC 43/0 was designed for window frame makers who have problems with drilling holes to fit the handle on wood, wood/aluminium and PVC windows.



TRIMATIC SUPER can be easily and quickly mounted on the multi-spindles head of any automatic boring machine with 32 mm distance between centres chucks.

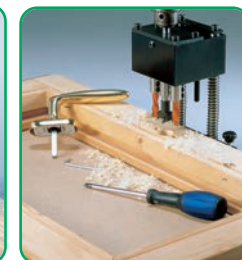
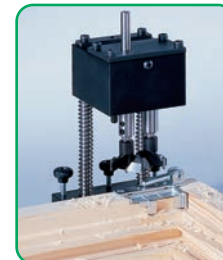

TRIMATIC are dedicated to craftsmen and hobbyists who have drilling problems when fitting hinges or positioning shelves with holes at a distance between centres of 32 mm.